

# Systems in Motion



Conveyor Solutions

A SYSTEMS IN MOTION COMPANY



A SYSTEMS IN MOTION COMPANY



A SYSTEMS IN MOTION COMPANY



A SYSTEMS IN MOTION COMPANY



# Chef Works®

## Chef Works Project Fun Facts

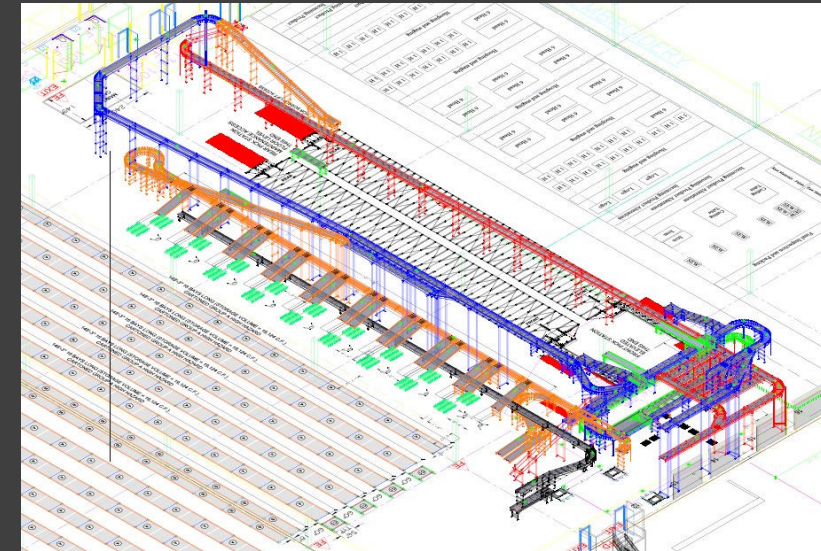

# Situation/Solution

- Company was running out of space and had very old equipment

- So we updated equipment and made it more automated. (see following slides for all that was installed)

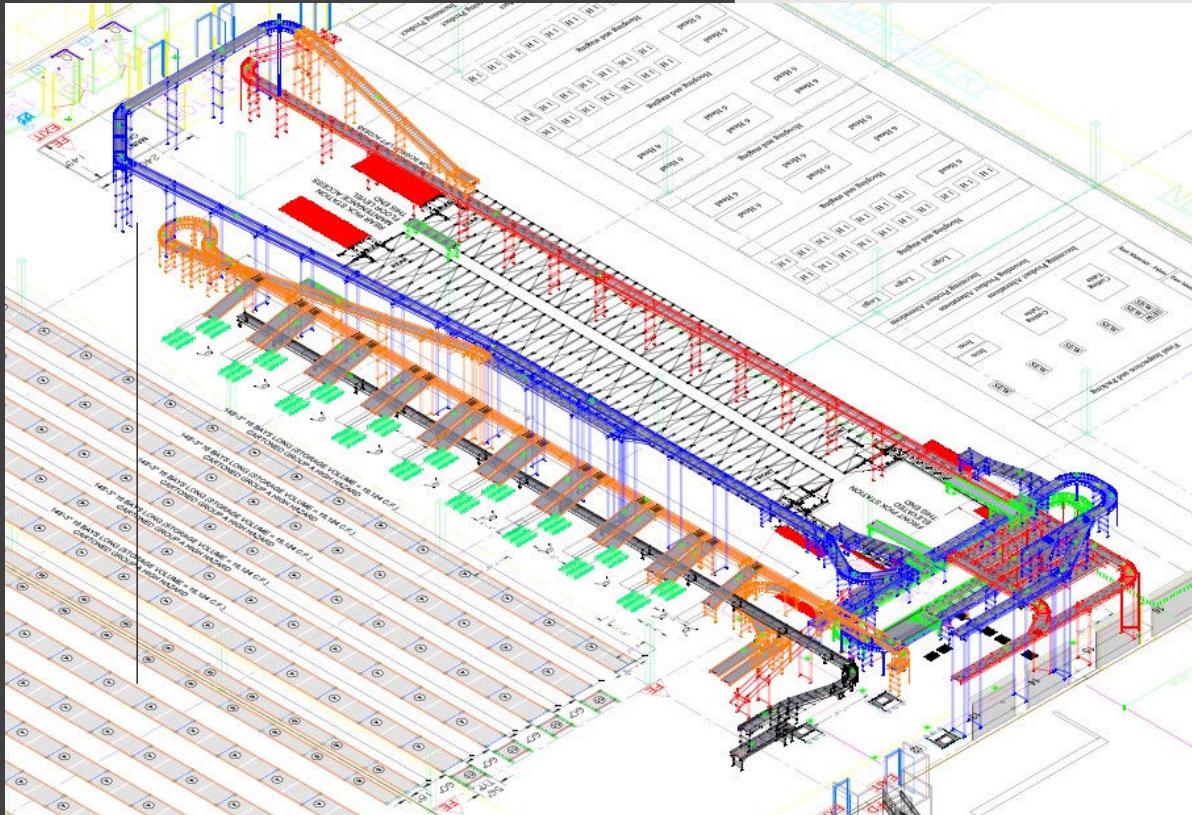

# Different Types of Equipment

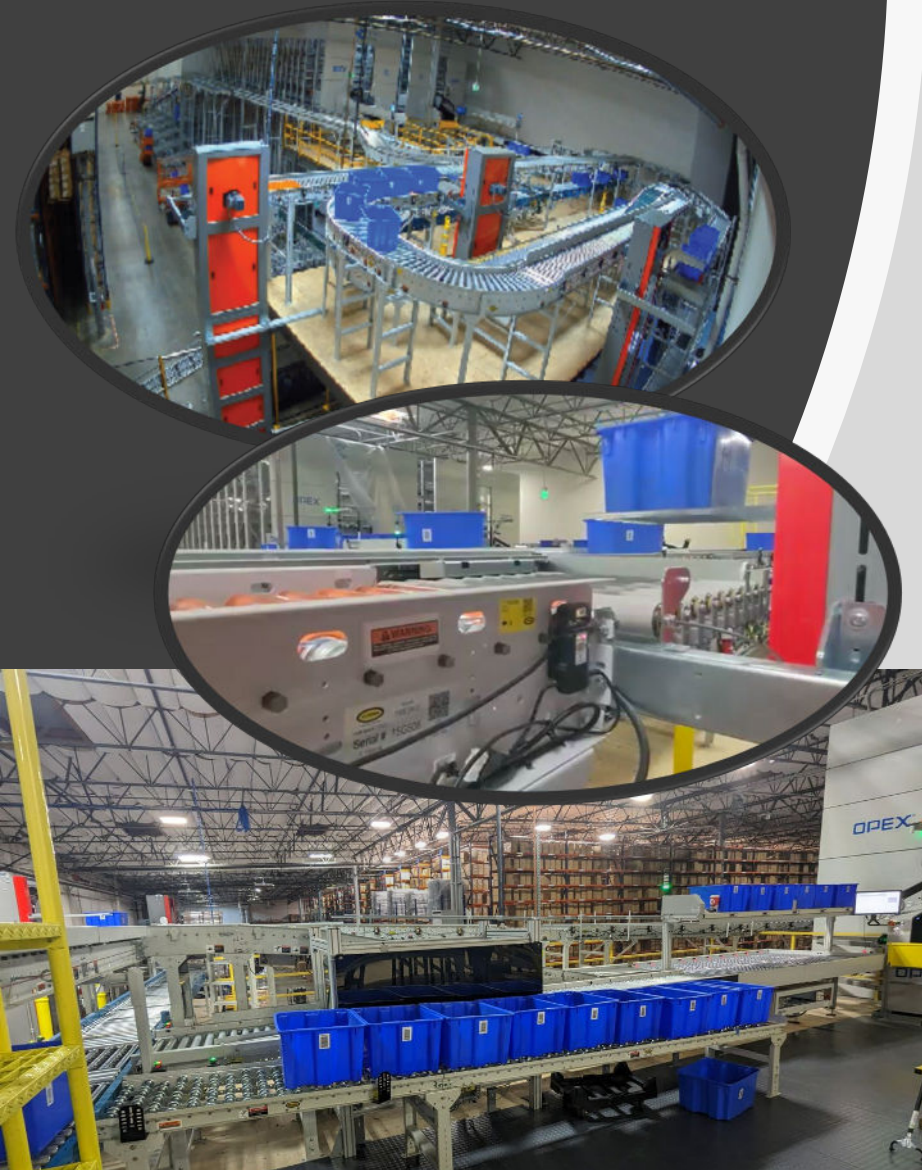

Systems in Motion

## Equipment Fun Facts for Chef Works Project

7,626 SKU locations currently (1 Sku per OPEX Storage Tote)

106' long storage currently - expandible to 130' long storage matrix

850 SKU presentations per hour

2 primary pick locations each with 5 Put to Light zones

2 Pick / Replenish locations each with 5 Pick/Put to Light zones

Reduced forward pick sq. ft. requirements by 40% using full height ceiling capacity

Consolidation of orders to VAS area

Combination of orders from VAS and Stock locations to 18 pack stations

Automatic Tote induction when orders are available from WMS

16 Cameras/Scanners

24 divers operated by KOZ Software (WCS)

Reduced total container volume by 38%



# 2 OPEX Aisles

- 7,626 SKU locations currently (1 Sku per OPEX Storage Tote)
- Designed for replenishment per full vendor case volume
- 106' long storage currently - expandible to 130' long storage matrix
- 850 SKU presentations per hour
- 2 primary pick locations each with 5 Put to Light zones
- 2 Pick / Replenish locations each with 5 Pick/Put to Light zones
- Reduced forward pick sq. ft. requirements by 40% using full height ceiling capacity



# Electrical & Controls

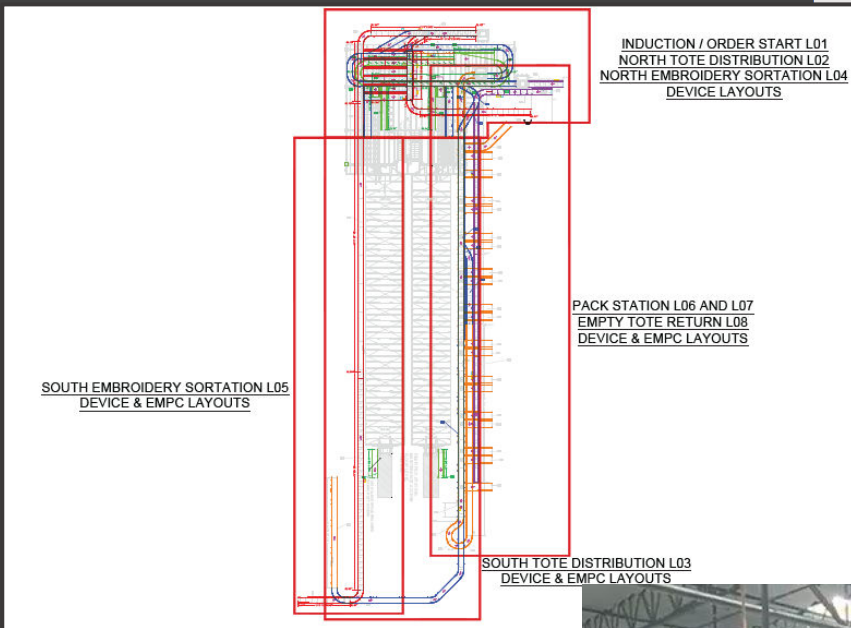

- Consolidation of orders to VAS area
- Combination of orders from VAS and Stock locations to 18 pack stations
- Automatic Tote induction when orders are available from WMS
- 16 Cameras/Scanners
- 24 diverts operated by KOZ Software (WCS)
- Powered by one Primary panel and 2 sub-I/O panels
- 2 computer Command Centers for Supervisor access
- Open and accessible database for custom customer dashboards



# Results



Reduced total container volume by **38%**



Reduced forward pick sq. ft. requirements by **40%** using full height ceiling capacity



Increased SKU locations - **7,626 SKU** locations currently (1 Sku per OPEX Storage Tote)

